

ROCKWOOL[®]

Technical Datasheet

DUROCK - C

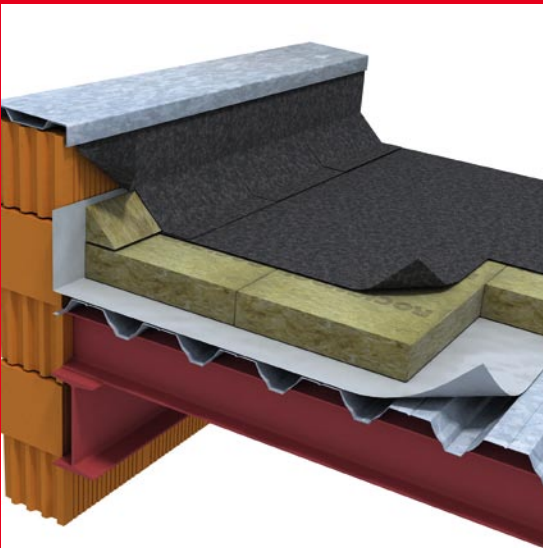

Segment of application
Flat roof

DUROCK - C

Dual-density thermal insulating slab for singlelayered flat roof insulation

PRODUCT DESCRIPTION

Dual-density step proof mineral wool slab. Water repellent across full section. Excellent for high point loads.

APPLICATIONS

Rockwool Durock is a dual-density slab with high elasticity and lower than average density compared to standard mono-lite slabs for flat roofs. We recommend it for thermal insulation of singlelayered flat roofs. Its high compression strength enables significant roofing loads. In addition the dual-density structure of Durock gives it excellent point load performance. It is perfect for use in combination with PVC or TPO single layer membranes, not least because of good elastic support to the mechanical fixings. The slabs have very high density top layer, approx. 20 mm thick and clearly marked, which should always be installed topside up.

PROPERTIES OF ROCKWOOL MINERAL WOOL

Rockwool Durock is an excellent thermal insulator. It is not flammable when exposed to open flame and does not generate smoke nor burning droplets. It helps to prevent the spread of fire. It has very good acoustic properties and helps to reduce the noise transmission from outdoor environment into the building. Rockwool Durock slabs are water repellent through the whole section and at the same time diffusion open for the vapour transmission.

PACKAGING

Rockwool Durock slabs are being produced and delivered in a big format only, packed on a wooden pallet. Pallet is covered with PE plastic cover hood.

DIMENSIONS, PRODUCT RANGE AND PACKAGING

Thickness (mm)	60	80	100	120	140	160	180
Length x width (mm)	2000 x 1200						
pcs / pallet	20	14	12	10	8	8	7
m ² / pallet	48.0	33.6	28.8	24.0	19.2	19.2	16.8

TECHNICAL PARAMETERS

Property	Symbol	Value	Unit	Standard
Reaction to fire	-	A1	-	EN 13501 - 1
Declared coefficient of thermal conductivity	λ_D	0.040	W/mK	EN 12667
Water vapour transmission	μ	1.4	-	EN 12086
Nominal bulk density	ρ	220/140 (top/bottom)	kg/m ³	EN 1602
Thickness tolerance	T5	-1 +3	mm	EN 823
Compressive stress at 10% deformation	CS(10)50	≥ 50	kPa	EN 826
Water absorption at short time immersing in water	WS	≤ 1,0	kg/m ²	EN 1609
Water absorption at long time immersing at water	WL(P)	≤ 3,0	kg/m ²	EN 12087
Point load-bearing capacity	PL(5)600	≥ 600	kPa	EN 12430
Melting point	T _t	> 1000	°C	DIN 4102
CE - certificate number	ACERMI EC - certificate of conformity 1163 - CPD - 0189			

Current HSE 'CHIP' Regulations and EU directive 97/69/EC confirm the safety of Rockwool.

Any information contained in this document describes the product properties applicable as at the time of issue. Please require from your supplier always the most recent issue of this Technical datasheet, because with respect to continuous product development, we retain the right to change some values without prior notice.

ROCKWOOL®
F I R E S A F E I N S U L A T I O N